

EP26 Cleaning and Maintenance - Revised 03/15/23

Changes: The center bolt and hook blade now have reverse threads to help keep everything tight. To tighten the bolt, turn the bolt counterclockwise. To loosen the bolt turn it clockwise. This is reverse from previous generation of tool.

Cleaning

- Do not spray the equipment with water or immerse it in water, otherwise it may cause electric shock and damage to the pruner.
- Keep the handle of the ventilation tank, engine room and equipment clean.
- Clean with a damp cloth or brush.
- Do not use detergents.
- Please clean the blade carefully after each use.
- Wipe the blade with an oily cloth.
- After 8 hours of continuous operation, please disassemble the front cover of the equipment to clean the wood chips and other impurities.

Disassembly and Assembly Maintenance Steps

General maintenance, cleaning, lubrication, and blade replacement requires some disassembly and assembly of your ePruner.

The cover is fastened to the pruner by 2 screws. The center bolt is secured with an adjustable gear nut which is locked into place by a gear nut clip. The gear nut clip is secured by a single bolt.

With the removal of the of the cover, adjustment clip, gear nut, and center bolt you can access, maintain, clean, lubricate and replacement of blades when necessary.

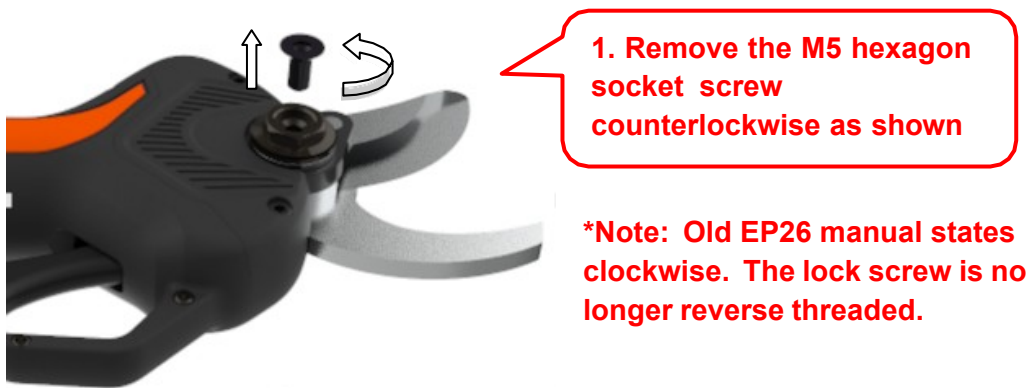



2. Remove the nut clockwise as shown and remove the flat needle roller bearing.

***Note: Old EP26 manual states counterclockwise. The new bolt and counter blade and nut is reverse threaded.**



3. Remove the hexagon socket screw by rotating clockwise* as shown.

***Note: Old EP26 manual states counterclockwise. The new bolt, nut and counter blade is reverse threaded.**



4. Turn counterclockwise as shown in the picture, remove the M3 screw from the blade cover.

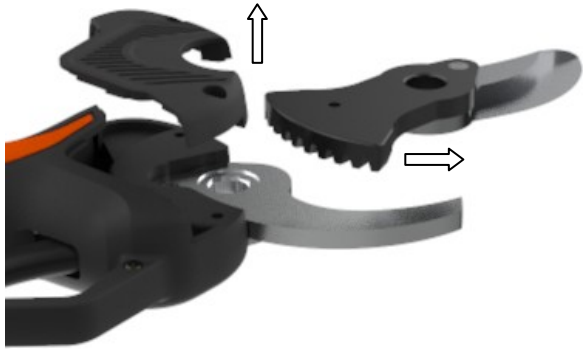

5. According to the direction shown in the picture, remove the blade cover and take the blade.



6. Clean up the plant debris as shown and grease it.

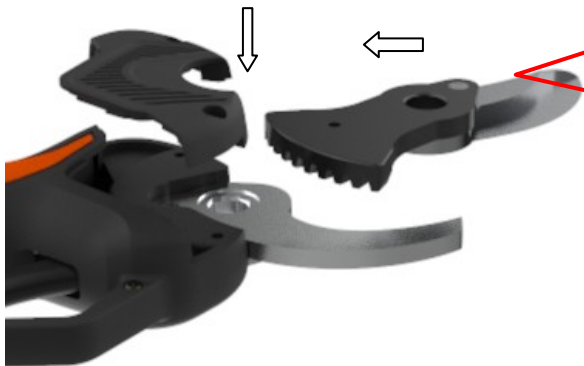

7. According to the direction shown in the diagram, put the moving blade in and cover the blade cover.



8. Screw the M3 hexagon socket screw as shown.



9. Twist the inner hexagon blade screw counterclockwise* as shown.

*Note: Old EP26 manual states clockwise. The new bolt and counter blade are reverse threaded.



10. Place the flat needle roller bearing as shown and screw on the locking nut.



11. Screw the M5 hexagon socket countersunk head clockwise as shown.



12. Reduce the friction between the two blade planes by adding oil as shown in the figure.

Tool Calibration

If a repair replacement motor or drive plate is required, the pruners need to be recalibrated.

Calibration Steps

- 1) Remove the upper and lower blades.
- 2) Insert the battery.
- 3) Hold down the trigger and remain motionless. Press the POWER switch again.
- 4) The trigger remains motionless for more than 20 seconds.
- 5) Release the trigger when you hear the motor turning.
- 6) The electric motor rotates during calibration. When the motor stops turning the calibration is complete.